

NOTICE!!

These documents have been scanned!

Do not place un-scanned documents beneath this notice!

Do not remove this notice from this file!

GPO Jacket No. 560-102
Print Order 61540
Rise Business Services, LLC
Job=AZ15 5/15/2019



Box Number= AZ15051



Claim Begin-End: AMC413977-AMC413978

1 Initial Receipt



AZ15051-8

AMC413769-AMC414062

**NO
DOCUMENTS
FOUND**

NO DOCUMENTS FOUND
NO DOCUMENTS FOUND

NOTICE!!

These documents have been scanned!

Do not place un-scanned documents beneath this notice!

Do not remove this notice from this file!

GPO Jacket No. 560-102
Print Order 61540
Rise Business Services, LLC
Job=AZ15 5/15/2019



Box Number= AZ15051



Claim Begin-End: AMC413977-AMC413978

2 Correspondence



AZ15051-8

AMC413769-AMC414062

**NO
DOCUMENTS
FOUND**

NO DOCUMENTS FOUND
NO DOCUMENTS FOUND

NOTICE!!

These documents have been scanned!

Do not place un-scanned documents beneath this notice!

Do not remove this notice from this file!

GPO Jacket No. 560-102
Print Order 61540
Rise Business Services, LLC
Job=AZ15 5/15/2019



Box Number= AZ15051



Claim Begin-End: AMC413977-AMC413978

3 Transfers

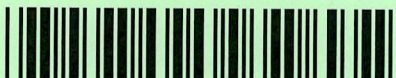

AZ15051-8

AMC413769-AMC414062

**NO
DOCUMENTS
FOUND**

NO DOCUMENTS FOUND
NO DOCUMENTS FOUND

NOTICE!!

These documents have been scanned!

Do not place un-scanned documents beneath this notice!

Do not remove this notice from this file!

GPO Jacket No. 560-102
Print Order 61540
Rise Business Services, LLC
Job=AZ15 5/15/2019



Box Number= AZ15051



Claim Begin-End: AMC413977-AMC413978

4 Miscellaneous



AZ15051-8

AMC413769-AMC414062

BLUE FIRE GEM CO LLC
PO BOX 1916
TUBAC AZ 85646

CERTIFIED MAIL™

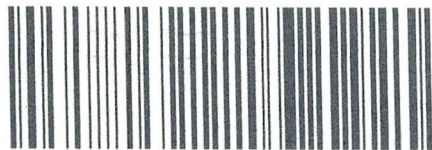

7011 0470 0000 1894 3023

US DEPT OF THE INTERIOR
BUREAU LAND MANAGEMENT
LANDS/RECREATION & PLANNING
ONE N CENTRAL AVENUE
PHOENIX AZ 85004-2203

85004-2203

TUCSON AZ 857

15 FEB 2012



UNITED STATES POSTAL SERVICE

02 1P

0001678955 FEB 13 2012

MAILED FROM ZIP CODE 85646

\$ 005.95⁰

PITNEY BOWES



USA FIRST CLASS FOREVER

PHOENIX, AZ 85004

2012 FEB 14 PM 1:25

BLM RECEIVED
- OFFICE



United States Department of the Interior
Bureau of Land Management
LANDS/RECREATION & PLANNING
ONE N CENTRAL AVE
PHOENIX, AZ 85004 -2203
Phone: 602-417-9200

Receipt

No: 2516295

Transaction #: 2593802
Date of Transaction: 02/15/2012

ENTERED INTO COMPUTER

CUSTOMER:

FEB 24 2012 *RB*

BLUE FIRE GEM COMPANY LLC
PO BOX 1916
TUBAC, AZ 85646-1916 US

LINE #	QTY	DESCRIPTION	REMARKS	UNIT PRICE	TOTAL
1	2.00	LOCATABLE MINERALS / MINING CLAIMS-NEW, UNADJUD, ONE OR MORE AUTH NOS / NEW MINING CLAIM LOCATION FEE \$34 CASES: AMC413977/\$34.00, AMC413978/\$34.00		- n/a -	68.00
2	2.00	LOCATABLE MINERALS / MINING CLAIMS-NEW, UNADJUD, ONE OR MORE AUTH NOS / NEW MINING CLAIM MAINT FEE \$140 CASES: AMC413977/\$140.00, AMC413978/\$140.00		- n/a -	280.00
3	2.00	LOCATABLE MINERALS / MINING CLAIMS-NEW, UNADJUD, ONE OR MORE AUTH NOS / NEW MINING CLAIM PROCESSING FEE \$15 CASES: AMC413977/\$15.00, AMC413978/\$15.00		- n/a -	30.00
TOTAL:					\$378.00

PAYMENT INFORMATION

1	AMOUNT:	189.00	POSTMARKED:	02/13/2012
	TYPE:	CHECK	RECEIVED:	02/15/2012
	CHECK NO:	1131		
	NAME:	BLUE FIRE GEM COMPANY LLC PO BOX 1916 TUBAC AZ 85646-1916 US		
2	AMOUNT:	189.00	POSTMARKED:	02/13/2012
	TYPE:	CHECK	RECEIVED:	02/15/2012
	CHECK NO:	1132		
	NAME:	BLUE FIRE GEM COMPANY LLC PO BOX 1916 TUBAC AZ 85646-1916 US		

NOTICE!!

These documents have been scanned!

Do not place un-scanned documents beneath this notice!

Do not remove this notice from this file!

GPO Jacket No. 560-102
Print Order 61540
Rise Business Services, LLC
Job=AZ15 5/15/2019



Box Number= AZ15051



Claim Begin-End: AMC413977-AMC413978

5 Annual Filings



AZ15051-8

AMC413769-AMC414062

UNITED STATES
DEPARTMENT OF THE INTERIOR
BUREAU OF LAND MANAGEMENT
**MAINTENANCE FEE PAYMENT FORM FOR
LODE CLAIMS, MILL SITES, AND TUNNEL SITES**

Amc410427
413977

Remitter Name: Bluefire Gem Co., LLC.

Mailing Address: P.O. Box 4688

City, State, Zip: Tubac, Az. 85646

☐ Check here if this is a change of address.

FOR COUNTY RECORDER'S USE

No. of claims/sites 15
x \$155 per claim/site
Total due BLM \$ 2325⁰⁰

1. The maintenance fee may be paid by cash, check, money order, Bureau of Land Management (BLM) Declining Deposit Account, or credit card (VISA, American Express, Discover, or MasterCard). Payments must be remitted to the BLM State Office where your claim or site is recorded and received on or before September 1. If the payment is mailed, the envelope must be postmarked by a bona fide delivery service on or before September 1 and received at the proper BLM State Office within 15 calendar days after the due date. Payments may also be made by telephone using a credit card. A complete listing of BLM State Offices with their addresses and phone numbers can be found at <http://www.blm.gov>.
2. The maintenance fee for the following claim(s)/site(s) applies to the assessment year 2019

CLAIM/SITE NAME	BLM SERIAL NO.
Closed To Entry #8	410 - 431
Closed To Entry #9	410 - 432
Closed To Entry #10	410 - 433
Closed To Entry #11	410 - 434
Closed To Entry #12	410 - 435
Closed To Entry #13	410 - 436
Closed To Entry #14	410 - 437
Closed To Entry #15	410 - 438
Closed To Entry #16	413 - 978
Closed To Entry #17	413 - 977

Use a separate sheet for additional claim/site names, serial numbers, and claimant names and addresses.

(Continued on page 2)

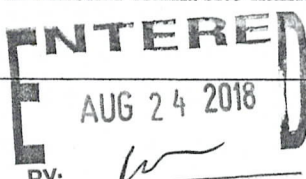

#4237014

UNITED STATES
DEPARTMENT OF THE INTERIOR
BUREAU OF LAND MANAGEMENT
**MAINTENANCE FEE PAYMENT FORM FOR
LODE CLAIMS, MILL SITES, AND TUNNEL SITES**

Remitter Name: Bluefire Gem Co. LLC

Mailing Address: P.O. Box 4688

City, State, Zip: Tubac, Az, 85646

☐ Check here if this is a change of address.

FOR COUNTY RECORDER'S USE

No. of claims/sites 15

x \$155 per claim/site

Total due BLM \$ 2325⁰⁰

1. The maintenance fee may be paid by cash, check, money order, Bureau of Land Management (BLM) Declining Deposit Account, or credit card (VISA, American Express, Discover, or MasterCard). Payments must be remitted to the BLM State Office where your claim or site is recorded and received on or before September 1. If the payment is mailed, the envelope must be postmarked by a bona fide delivery service on or before September 1 and received at the proper BLM State Office within 15 calendar days after the due date. Payments may also be made by telephone using a credit card. A complete listing of BLM State Offices with their addresses and phone numbers can be found at <http://www.blm.gov>.
2. The maintenance fee for the following claim(s)/site(s) applies to the assessment year 2019

CLAIM/SITE NAME	BLM SERIAL NO.
<u>Van Nostrand-McCafferty Mine #1</u>	<u>410-444</u>
<u>Van Nostrand-McCafferty Mine #2</u>	<u>410-445</u>
<u>Van Nostrand-McCafferty Mine #3</u>	<u>410-446</u>
<u>Van Nostrand-McCafferty Mine #4</u>	<u>410-447</u>
<u>Van Nostrand-McCafferty Mine #5</u>	<u>410 448</u>

RECEIVED
BLM AZ STATE OFFICE
2018 AUG 15 P 2:30
PHOENIX, ARIZONA

Use a separate sheet for additional claim/site names, serial numbers, and claimant names and addresses.

**United States Department of the Interior
Bureau of Land Management**

DIV OF LANDS, MINRLS & ENERGY

ONE N CENTRAL AVE

PHOENIX, AZ 85004 -4427

Phone: 602-417-9200

Receipt

No:

4237014

Transaction #: 4352395**Date of Transaction:** 08/16/2018

CUSTOMER:

BLUE FIRE GEM COMPANY LLC
PO BOX 4688
TUBAC, AZ 85646-4688 US

LINE #	QTY	DESCRIPTION	REMARKS	UNIT PRICE	TOTAL
1	1.00	LOCATABLE MINERALS / MINING CLAIMS- NOT NEW-UNADJUD, ONE AUTH NO. ONLY / MINING CLAIM MONEY RECEIVED CASES: AMC410431/\$2325.00	MAINT 2019/15	- n/a -	2325.00
TOTAL:					\$2,325.00

PAYMENT INFORMATION

1	AMOUNT:	2325.00	POSTMARKED:	N/A
	TYPE:	CHECK	RECEIVED:	08/15/2018
	CHECK NO:	1211		
	NAME:	BLUE FIRE GEM COMPANY LLC PO BOX 4688 TUBAC AZ 85646-4688 US		

REMARKS

This receipt was generated by the automated BLM Collections and Billing System and is a paper representation of a portion of the official electronic record contained therein.

Southern Skies Opal, LLC
P.O. Box ~~4688~~ 4688
Tubac, AZ 85646-~~4688~~
732-233-6366

RECEIVED
STATE OFFICE
2018 AUG 15 P 2:36
PHOENIX, ARIZONA

CERTIFIED MAIL



7015 0640 0007 5501 4287



U.S. OFFICIAL MAIL **US POSTAGE**
PENALTY FOR
PRIVATE USE **\$06.67⁰**
\$300 **First-Class**
Mailed From 85646
08/13/2018
032A 0061856771

Bureau of Land Management
One North Central Ave.
Suite 800 (8th Floor)
Phoenix, Az.



85004-4427

8500434427 C041

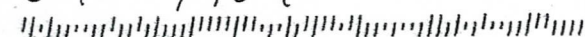

UNITED STATES
DEPARTMENT OF THE INTERIOR
BUREAU OF LAND MANAGEMENT

**MAINTENANCE FEE PAYMENT FORM FOR
LODE CLAIMS, MILL SITES, AND TUNNEL SITES**

410427
413977

Remitter Name: Bluefire Gem Co. LLC.

Mailing Address: P.O. Box 4688

City, State, Zip: Tubac, Az. 85646

☐ Check here if this is a change of address.

FOR COUNTY RECORDER'S USE

No. of claims/sites 15
x \$155 per claim/site
Total due BLM \$ 2325⁰⁰

- The maintenance fee may be paid by cash, check, money order, Bureau of Land Management (BLM) Declining Deposit Account, or credit card (VISA, American Express, Discover, or MasterCard). Payments must be remitted to the BLM State Office where your claim or site is recorded and received on or before September 1. If the payment is mailed, the envelope must be postmarked by a bona fide delivery service on or before September 1 and received at the proper BLM State Office within 15 calendar days after the due date. Payments may also be made by telephone using a credit card. A complete listing of BLM State Offices with their addresses and phone numbers can be found at <http://www.blm.gov>.
- The maintenance fee for the following claim(s)/site(s) applies to the assessment year 2018

CLAIM/SITE NAME	BLM SERIAL NO.
Closed To Entry #8	410-431 7
Closed To Entry #9	410-432
Closed To Entry #10	410-433
Closed To Entry #11	410-434
Closed To Entry #12	410-435
Closed To Entry #13	410-436
Closed To Entry #14	410-437
Closed To Entry #15	410-438
Closed To Entry #16	413-978 1
Closed To Entry #17	413-979

Use a separate sheet for additional claim/site names, serial numbers, and claimant names and addresses.

3932392

(Continued on page 2)

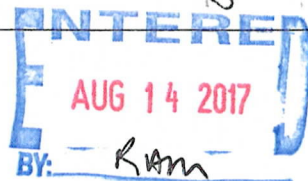

UNITED STATES
DEPARTMENT OF THE INTERIOR
BUREAU OF LAND MANAGEMENT
MAINTENANCE FEE PAYMENT FORM FOR
LODE CLAIMS, MILL SITES, AND TUNNEL SITES

Remitter Name: Blue Fire Gem Co. LLC.

Mailing Address: P.O. Box 4688

City, State, Zip: Tubac, Az. 85646

☐ Check here if this is a change of address.

FOR COUNTY RECORDER'S USE

No. of claims/sites 15
x \$155 per claim/site
Total due BLM \$ 2325.00

1. The maintenance fee may be paid by cash, check, money order, Bureau of Land Management (BLM) Declining Deposit Account, or credit card (VISA, American Express, Discover, or MasterCard). Payments must be remitted to the BLM State Office where your claim or site is recorded and received on or before September 1. If the payment is mailed, the envelope must be postmarked by a bona fide delivery service on or before September 1 and received at the proper BLM State Office within 15 calendar days after the due date. Payments may also be made by telephone using a credit card. A complete listing of BLM State Offices with their addresses and phone numbers can be found at <http://www.blm.gov>.
2. The maintenance fee for the following claim(s)/site(s) applies to the assessment year 2018

CLAIM/SITE NAME	BLM SERIAL NO.
<u>Van Nostrand-McCafferty Mine #1</u>	<u>410-4447</u>
<u>Van Nostrand-McCafferty Mine #2</u>	<u>410-445</u>
<u>Van Nostrand-McCafferty Mine #3</u>	<u>410-446</u>
<u>Van Nostrand-McCafferty Mine #4</u>	<u>410-447</u>
<u>Van Nostrand-McCafferty Mine #5</u>	<u>410-448</u>

Use a separate sheet for additional claim/site names, serial numbers, and claimant names and addresses.

Bluefire Gem LLC.
P.O. Box 4688
Tubac, Az 85646

CERTIFIED MAIL

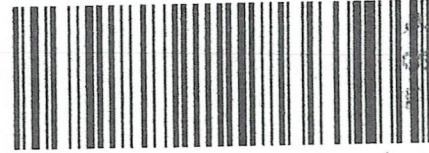

PHOENIX
AZ 852
09 AUG '17
PM 4 L

7016 0910 0001 2771 6950



UNITED STATES POSTAGE
PITNEY BOWES
02 1P
\$ 006.59⁰
0000242016 AUG 09 2017
MAILED FROM ZIP CODE 85646

RECEIVED
BLM AZ STATE OFFICE

2017 AUG 10 P 2:52

PHOENIX, ARIZONA

BLM
AZ STATE OFFICE
ONE NORTH Central Ave st. 800
Phoenix, Az.
85004-4427

85004-442700

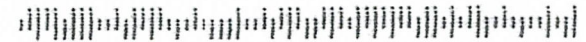

United States Department of the Interior
Bureau of Land Management
DIV OF LANDS, MINRLS & ENERGY
ONE N CENTRAL AVE
PHOENIX, AZ 85004 -4427
Phone: 602-417-9200

Receipt

No: 3932392

Transaction #: 4041966**Date of Transaction:** 08/11/2017**CUSTOMER:**

BLUE FIRE GEM COMPANY LLC
PO BOX 4688
TUBAC, AZ 85646-4688 US

LINE #	QTY	DESCRIPTION	REMARKS	UNIT PRICE	TOTAL
1	1.00	LOCATABLE MINERALS / MINING CLAIMS- NOT NEW-UNADJUD, ONE AUTH NO. ONLY / MINING CLAIM MONEY RECEIVED CASES: AMC410431/\$2325.00	MAINT 2018/15	- n/a -	2325.00
TOTAL:					\$2,325.00

PAYMENT INFORMATION

1	AMOUNT:	2325.00	POSTMARKED:	08/09/2017
	TYPE:	CHECK	RECEIVED:	08/10/2017
	CHECK NO:	1209		
	NAME:	BLUE FIRE GEM COMPANY LLC PO BOX 4688 TUBAC AZ 85646-4688 US		

REMARKS

This receipt was generated by the automated BLM Collections and Billing System and is a paper representation of a portion of the official electronic record contained therein.

UNITED STATES
DEPARTMENT OF THE INTERIOR
BUREAU OF LAND MANAGEMENT
MAINTENANCE FEE PAYMENT FORM FOR
LODE CLAIMS, MILL SITES, AND TUNNEL SITES

410427

413977

Remitter Name: Blue Fire Gem Co. LLCMailing Address: P.O. Box 4688City, State, Zip: Tubac, Az, 85646☐ Check here if this is a change of address.

FOR COUNTY RECORDER'S USE

No. of claims/sites 19
x \$155 per claim/site
Total due BLM \$ 2945.00

1. The maintenance fee may be paid by cash, check, money order, Bureau of Land Management (BLM) Declining Deposit Account, or credit card (VISA, American Express, Discover, or MasterCard). Payments must be remitted to the BLM State Office where your claim or site is recorded and received on or before September 1. If the payment is mailed, the envelope must be postmarked by a bona fide delivery service on or before September 1 and received at the proper BLM State Office within 15 calendar days after the due date. Payments may also be made by telephone using a credit card. A complete listing of BLM State Offices with their addresses and phone numbers can be found at <http://www.blm.gov>.
2. The maintenance fee for the following claim(s)/site(s) applies to the assessment year 2017

CLAIM/SITE NAME	BLM SERIAL NO.
CLOSED TO ENTRY #4	410 427
CLOSED TO ENTRY #5	410 428
CLOSED TO ENTRY #6	410 429
CLOSED TO ENTRY #7	410 430
CLOSED TO ENTRY #8	410 431
CLOSED TO ENTRY #9	410 432
CLOSED TO ENTRY #10	410 433
CLOSED TO ENTRY #11	410 434
CLOSED TO ENTRY #12	410 435
CLOSED TO ENTRY #13	410 436

Use a separate sheet for additional claim/site names, serial numbers, and claimant names and addresses.

(Continued on page 2)

BY: Rm

AUG 26 2016

RECEIVED
BLM AZ STATE OFFICERECEIPT # 3640680

UNITED STATES
DEPARTMENT OF THE INTERIOR
BUREAU OF LAND MANAGEMENT
MAINTENANCE FEE PAYMENT FORM FOR
LODE CLAIMS, MILL SITES, AND TUNNEL SITES

Page 2

Remitter Name: BlueFireGem Co. LLC
Mailing Address: P.O. Box 4688
City, State, Zip: Tubac, Az. 85646☐ Check here if this is a change of address.

FOR COUNTY RECORDER'S USE

No. of claims/sites 19
x \$155 per claim/site
Total due BLM \$ _____

1. The maintenance fee may be paid by cash, check, money order, Bureau of Land Management (BLM) Declining Deposit Account, or credit card (VISA, American Express, Discover, or MasterCard). Payments must be remitted to the BLM State Office where your claim or site is recorded and received on or before September 1. If the payment is mailed, the envelope must be postmarked by a bona fide delivery service on or before September 1 and received at the proper BLM State Office within 15 calendar days after the due date. Payments may also be made by telephone using a credit card. A complete listing of BLM State Offices with their addresses and phone numbers can be found at <http://www.blm.gov>.
2. The maintenance fee for the following claim(s)/site(s) applies to the assessment year 2017

CLAIM/SITE NAME	BLM SERIAL NO.
CLOSED TO ENTRY #14	410 437
CLOSED TO ENTRY #15	410 438
CLOSED TO ENTRY #16	410 413 978
CLOSED TO ENTRY #17	410 413 977
Van Nostrand-M ^c Cafferty Mine #1	410 444
Van Nostrand-M ^c Cafferty Mine #2	410 445
Van Nostrand-M ^c Cafferty Mine #3	410 446
Van Nostrand-M ^c Cafferty Mine #4	410 447
Van Nostrand-M ^c Cafferty Mine #5	410 448
PHOENIX, ARIZONA	

Use a separate sheet for additional claim/site names, serial numbers, and claimant names and addresses.

(Continued on page 2)

RECEIVED
BLM AZ STATE OFFICE
2017 AUG 24 P 1:25

Southern SKres Opal
P.O. Box 4688
Tubac, Az.

CERTIFIED MAIL PHOENIX

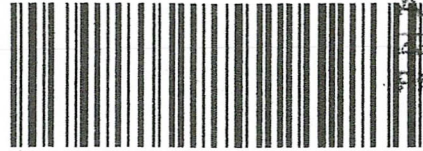

7015 0640 0007 5501 4300



1000



85004

U.S. POSTAGE
PAID
GREEN VALLEY, AZ
85614
AUG 22, 16
AMOUNT

\$6.47

R2304M112163-1

85646
RETURN RECEIPT
REQUESTED
BIM AZ STATE OFFICE
AUG 24 P 1:24
PHOENIX, ARIZONA

BIM
AZ STATE OFFICE Suite 800
ONE NORTH Central Ave.
Phoenix, Az.
85004-4427

85004\$4427 C041

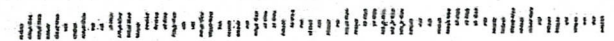

United States Department of the Interior
Bureau of Land Management
DIV OF LANDS, MINRLS & ENERGY
ONE N CENTRAL AVE
PHOENIX, AZ 85004 -4427
Phone: 602-417-9200

Receipt

No: 3640680

Transaction #: 3744625
Date of Transaction: 08/25/2016

CUSTOMER:

BLUE FIRE GEM COMPANY LLC
PO BOX 4688
TUBAC, AZ 85646-4688 US

LINE #	QTY	DESCRIPTION	REMARKS	UNIT PRICE	TOTAL
1	1.00	LOCATABLE MINERALS / MINING CLAIMS- NOT NEW-UNADJUD, ONE AUTH NO. ONLY / MINING CLAIM MONEY RECEIVED CASES: AMC410427/\$2945.00	MAINT FEE 2017 - 19	- n/a -	2945.00
TOTAL:					\$2,945.00

PAYMENT INFORMATION

1	AMOUNT:	2945.00	POSTMARKED:	08/22/2016
	TYPE:	CHECK	RECEIVED:	08/24/2016
	CHECK NO:	2217		
	NAME:	SOUTHERN SKIES OPAL LLC PO BOX 1916 TUBAC AZ 85646-4688 US		

REMARKS

This receipt was generated by the automated BLM Collections and Billing System and is a paper representation of a portion of the official electronic record contained therein.

UNITED STATES
DEPARTMENT OF THE INTERIOR
BUREAU OF LAND MANAGEMENT
**MAINTENANCE FEE PAYMENT FORM FOR
LODE CLAIMS, MILL SITES, AND TUNNEL SITES**

410427
413977

Remitter Name: Blue Fire Gem Co. LLC.

Mailing Address: P.O. Box 4688

City, State, Zip: Tubac, Az. 85646

☐ Check here if this is a change of address.

FOR COUNTY RECORDER'S USE

No. of claims/sites 19
x \$155 per claim/site
Total due BLM \$ 2945⁰⁰

1. The maintenance fee may be paid by cash, check, money order, Bureau of Land Management (BLM) Declining Deposit Account, or credit card (VISA, American Express, Discover, or MasterCard). Payments must be remitted to the BLM State Office where your claim or site is recorded and received on or before September 1. If the payment is mailed, the envelope must be postmarked by a bona fide delivery service on or before September 1 and received at the proper BLM State Office within 15 calendar days after the due date. Payments may also be made by telephone using a credit card. A complete listing of BLM State Offices with their addresses and phone numbers can be found at <http://www.blm.gov>.
2. The maintenance fee for the following claim(s)/site(s) applies to the assessment year 2016.

CLAIM/SITE NAME	BLM SERIAL NO.
CLOSED to entry #4	410427
CLOSED to entry #5	410428
CLOSED to entry #6	410429
CLOSED to entry #7	410430
CLOSED to entry #8	410431
CLOSED to entry #9	410432
CLOSED to entry #10	410433
CLOSED to entry #11	410434
CLOSED to entry #12	410435
CLOSED to entry #13	410436

Use a separate sheet for additional claim/site names, serial numbers, and claimant names and addresses.

(Continued on page 2)

ENTERED
AUG 23 2015
BY: 72

RECEIPT # 3377583

RECEIVED
2015 AUG 25 P 2:23
BLM AZONA

DEPARTMENT OF THE INTERIOR
BUREAU OF LAND MANAGEMENT

MAINTENANCE FEE PAYMENT FORM FOR
LODE CLAIMS, MILL SITES, AND TUNNEL SITES

Remitter Name: _____

Mailing Address: _____

City, State, Zip: _____

☐ Check here if this is a change of address.

FOR COUNTY RECORDER'S USE

No. of claims/sites _____

x \$155 per claim/site

Total due BLM \$ _____

- The maintenance fee may be paid by cash, check, money order, Bureau of Land Management (BLM) Declining Deposit Account, or credit card (VISA, American Express, Discover, or MasterCard). Payments must be remitted to the BLM State Office where your claim or site is recorded and received on or before September 1. If the payment is mailed, the envelope must be postmarked by a bona fide delivery service on or before September 1 and received at the proper BLM State Office within 15 calendar days after the due date. Payments may also be made by telephone using a credit card. A complete listing of BLM State Offices with their addresses and phone numbers can be found at <http://www.blm.gov>.
- The maintenance fee for the following claim(s)/site(s) applies to the assessment year 2016.

CLAIM/SITE NAME	BLM SERIAL NO.
CLOSED TO ENTRY # 14	410 437
CLOSED TO ENTRY # 15	410 438
CLOSED TO ENTRY # 16	413 978
CLOSED TO ENTRY # 17	413 977
VAN Nostrand-McCafferty Mine # 1	410 444
VAN Nostrand-McCafferty Mine # 2	410 445
VAN Nostrand-McCafferty Mine # 3	410 446
VAN Nostrand-McCafferty Mine # 4	410 447
VAN Nostrand-McCafferty Mine # 5	410 448

Use a separate sheet for additional claim/site names, serial numbers, and claimant names and addresses.

2015 AUG 25 PM 2:23
RECEIVED
BLM
ARIZONA

Blue Fire Gem Co
PO Box 4688

Tubac AZ

85646 RECEIVED
BEM AZ STATE OFFICE

2015 AUG 25 P 2:07

PHOENIX, ARIZONA

PHOENIX AZ 852

20 AUG 2015 PM 9 L

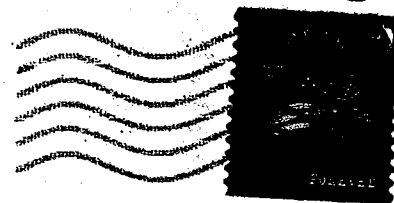

Bureau of Land Management
One North Central Ave, Ste 800
Phoenix AZ 85004-4427

85004442700



United States Department of the Interior
Bureau of Land Management
 LANDS/RECREATION & PLANNING
 ONE N CENTRAL AVE
 PHOENIX, AZ 85004 -2203
 Phone: 602-417-9200

Receipt

No: 3377583

Transaction #: 3475832

Date of Transaction: 08/26/2015

CUSTOMER:

BLUE FIRE GEM COMPANY LLC
 PO BOX 4688
 TUBAC, AZ 85646-4688 US

LINE #	QTY	DESCRIPTION	REMARKS	UNIT PRICE	TOTAL
1	1.00	LOCATABLE MINERALS / MINING CLAIMS-NOT NEW-UNADJUD, ONE AUTH NO. ONLY / MINING CLAIM MONEY RECEIVED CASES: AMC410427/\$2945.00	MANIT FEE PYMNT - 19 2016	- n/a -	2945.00
TOTAL:					\$2,945.00

PAYMENT INFORMATION

1	AMOUNT:	2945.00	POSTMARKED:	08/19/2015
	TYPE:	CHECK	RECEIVED:	08/25/2015
	CHECK NO:	1205		
	NAME:	BLUE FIRE GEM COMPANY LLC PO BOX 4688 TUBAC AZ 85646-4688 US		

REMARKS

This receipt was generated by the automated BLM Collections and Billing System and is a paper representation of a portion of the official electronic record contained therein.

8/26/2015

UNITED STATES
DEPARTMENT OF THE INTERIOR
BUREAU OF LAND MANAGEMENT
**MAINTENANCE FEE PAYMENT FORM FOR
LODE CLAIMS, MILL SITES, AND TUNNEL SITES**

410427
413977

Remitter Name: Blue Fire Gem Co, LLC.

Mailing Address: P.O. Box 4688

City, State, Zip: Tubac, Az. 85646

☐ Check here if this is a change of address.

FOR COUNTY RECORDER'S USE

No. of claims/sites 19

x \$155 per claim/site

Total due BLM \$ 2945.⁰⁰

- The maintenance fee may be paid by cash, check, money order, Bureau of Land Management (BLM) Declining Deposit Account, or credit card (VISA, American Express, Discover, or MasterCard). Payments must be remitted to the BLM State Office where your claim or site is recorded and received on or before September 1. If the payment is mailed, the envelope must be postmarked by a bona fide delivery service on or before September 1 and received at the proper BLM State Office within 15 calendar days after the due date. Payments may also be made by telephone using a credit card. A complete listing of BLM State Offices with their addresses and phone numbers can be found at <http://www.blm.gov>.
- The maintenance fee for the following claim(s)/site(s) applies to the assessment year 2015.

CLAIM/SITE NAME	BLM SERIAL NO.
CLOSED TO ENTRY #4	410 427
CLOSED TO Entry #5	410 428
CLOSED TO Entry #6	410 429
CLOSED TO Entry #7	410 430
CLOSED TO Entry #8	410 431
CLOSED TO Entry #9	410 432
CLOSED TO Entry #10	410 433
CLOSED TO Entry #11	410 434
CLOSED TO Entry #12	410 435
CLOSED TO Entry #13	410 436

Use a separate sheet for additional claim/site names, serial numbers, and claimant names and addresses.

(Continued on page 2)

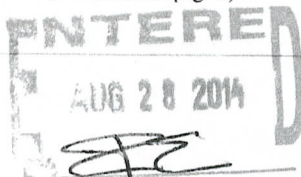

RECEIPT #

3112528

RECEIVED
BLM AZ STATE OFFICE
TUBAC, ARIZONA
AUG 25 P 2:10

UNITED STATES
DEPARTMENT OF THE INTERIOR
BUREAU OF LAND MANAGEMENT
**MAINTENANCE FEE PAYMENT FORM FOR
LODE CLAIMS, MILL SITES, AND TUNNEL SITES**

Remitter Name: Blue Fire Gem Co. LLC.Mailing Address: P.O. Box 4688City, State, Zip: Tubac, Az. 85646☐ Check here if this is a change of address.

FOR COUNTY RECORDER'S USE

No. of claims/sites 19
 x \$155 per claim/site
 Total due BLM \$ 2945.00

- The maintenance fee may be paid by cash, check, money order, Bureau of Land Management (BLM) Declining Deposit Account, or credit card (VISA, American Express, Discover, or MasterCard). Payments must be remitted to the BLM State Office where your claim or site is recorded and received on or before September 1. If the payment is mailed, the envelope must be postmarked by a bona fide delivery service on or before September 1 and received at the proper BLM State Office within 15 calendar days after the due date. Payments may also be made by telephone using a credit card. A complete listing of BLM State Offices with their addresses and phone numbers can be found at <http://www.blm.gov>.
- The maintenance fee for the following claim(s)/site(s) applies to the assessment year 2014.

CLAIM/SITE NAME	BLM SERIAL NO.
CLOSED To Entry #14	410 437
CLOSED To Entry #15	410 438
CLOSED To Entry #16	413 978
CLOSED To Entry #17	413 977
Van Nostrand-McCafferty Mine #1	410 444
Van Nostrand-McCafferty Mine #2	410 445
Van Nostrand-McCafferty Mine #3	410 446
Van Nostrand-McCafferty Mine #4	410 447
Van Nostrand-McCafferty Mine #5	410 448

Use a separate sheet for additional claim/site names, serial numbers, and claimant names and addresses.

(Continued on page 2)

RECEIVED
 BLM STATE OFFICE
 2014 AUG 25 P 2:10
 PHOENIX, ARIZONA

Blue Fire Gem Co, LLC,
P.O. Box 4688
Tubae, Az, 85646

RECEIVED
BLM AZ S OFFICE

2014 AUG 25 P 2:10

PHOENIX, ARIZONA

Bureau of Land Management
ARIZONA State Office
One N. Central Avenue
Phoenix, Az.

85004-2203

8500434414

CERTIFIED MAIL™

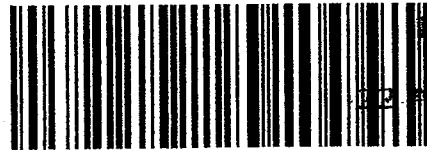

7013 3020 0001 7912 6288

PHOENIX AZ 852

22 AUG 2014 PM 5 L

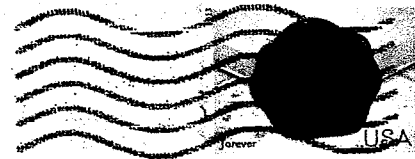

United States Department of the Interior
Bureau of Land Management
 LANDS/RECREATION & PLANNING
 ONE N CENTRAL AVE
 PHOENIX, AZ 85004 -2203
 Phone: 602-417-9200

Receipt

No: 3112528

Transaction #: 3204242	
Date of Transaction: 08/26/2014	
CUSTOMER:	
	BLUE FIRE GEM COMPANY LLC PO BOX 4688 TUBAC, AZ 85646-4688 US

LINE #	QTY	DESCRIPTION	REMARKS	UNIT PRICE	TOTAL
1	1.00	LOCATABLE MINERALS / MINING CLAIMS-NOT NEW-UNADJUD, ONE AUTH NO. ONLY / MINING CLAIM MONEY RECEIVED CASES: AMC410427/\$2945.00	MAINT FEE PYMNT (19) 2015	- n/a -	2945.00
TOTAL:					\$2,945.00

PAYMENT INFORMATION			
1	AMOUNT:	2945.00	POSTMARKED: 08/22/2014
	TYPE:	CHECK	RECEIVED: 08/25/2014
	CHECK NO:	1196	
	NAME:	BLUE FIRE GEM COMPANY LLC PO BOX 1916 TUBAC AZ 85646-4688 US	

REMARKS

This receipt was generated by the automated BLM Collections and Billing System and is a paper representation of a portion of the official electronic record contained therein.

AMC 414435

AMC 413977

MAINTENANCE FEE PAYMENT

Claimant Name: Bluefire Gem Co. LLCAddress: P.O. Box 4688City: Tubac State: Az Zip: 85646Telephone: 732-233-6366E-mail address: SouthernSkies@aol.com WEST OFFICE, NETSignature: [Signature]☒ Check here if this is a change of address.BLM
Date
Stamp

PHOENIX, ARIZONA

2013 AUG -9 PM 3:32

RECEIVED
BLM AZ STATE OFFICE

LINE NO.	AMC NUMBER	CLAIM/SITE NAME	COUNTY RECORDER DATA (If available)	TWP	RNG	SEC
1	410427	CLOSED TO ENTRY #4	2011-06853	22S	11E	20
2	410428	CLOSED TO ENTRY #5	2011-06854	22S	11E	20
3	410429	CLOSED TO ENTRY #6	2011-06855	22S	11E	20
4	410430	CLOSED TO ENTRY #7	2011-06856	22S	11E	20
5	410431	CLOSED TO ENTRY #8	2011-06857	22S	11E	25
6	410432	CLOSED TO ENTRY #9	2011-06858	22S	11E	25
7	410433	CLOSED TO ENTRY #10	2011-06859	22S	11E	25
8	410434	CLOSED TO ENTRY #11	2011-06860	22S	11E	25
9	410435	CLOSED TO ENTRY #12	2011-06861	22S	11E	25
10	410436	CLOSED TO ENTRY #13	2011-06862	22S	11E	25

List additional claims on Form MCF114.

Bureau of Land Management
Arizona State Office
www.blm.gov/az/No. of Claims 19 x \$140 = \$2660.00Check No: 1185 Init. AWReceipt No.: 2852453

For BLM Use Only

Form: MCF112
Revised July 2009

This form is available from the Arizona Department of Mines and Mineral Resources and may be reproduced.

ENTERED INTO COMPUTER

AUG 19 2013

TS

**May be used with the following forms for listing additional mining claims:
Check One.**

- BLM
Date
Stamp**

PHOENIX, ARIZONA

32 بی 9-133

RECEIVED
BLM AZ STATE OFFICE

[illegible]

Form MCF114
Revised June 2005

This form is available from the Arizona Department of Mines & Mineral Resources and may be reproduced.

United States Department of the Interior
Bureau of Land Management
LANDS/RECREATION & PLANNING
ONE N CENTRAL AVE
PHOENIX, AZ 85004 -2203
Phone: 602-417-9200

Receipt

No:

2852453

Transaction #: 2938208

Date of Transaction: 08/12/2013

CUSTOMER:

BLUE FIRE GEM COMPANY LLC
PO BOX 4688
TUBAC, AZ 85646-4688 US

LINE #	QTY	DESCRIPTION	REMARKS	UNIT PRICE	TOTAL
1	1.00	LOCATABLE MINERALS / MINING CLAIMS-NOT NEW-UNADJUD, ONE AUTH NO. ONLY / MINING CLAIM MONEY RECEIVED CASES: AMC410427/\$2660.00	MAINT FEE PYMNT (19) 2014	- n/a -	2660.00
TOTAL:					\$2,660.00

PAYMENT INFORMATION					
1	AMOUNT:	2660.00		POSTMARKED:	08/08/2013
	TYPE:	CHECK		RECEIVED:	08/09/2013
	CHECK NO:	1185			
	NAME:	BLUE FIRE GEM COMPANY LLC PO BOX 1916 TUBAC AZ 85646-4688 US			

REMARKS

This receipt was generated by the automated BLM Collections and Billing System and is a paper representation of a portion of the official electronic record contained therein.

410427

413977

Authorized Date 10/16/2012

AZ BLM REFUND \$10 TO DWIGHT WILLIAMS FOR

Instructions to Accounts OVERPAYMENT OF MAINTENANCE FEES FOR AMC417345.

RECEIPT# 2647440. RE.

Login ID 4105

Entry Date 10/16/2012

Total Amount \$140.00

Amc 410 427
Amc 413977

MAINTENANCE FEE PAYMENT Bluefire Gold Co. LLC

Claimant Name: Bluefire Gem Co. LLC

Address: P.O. Box 1916

City: Tubac State: AZ Zip: 85646

Telephone: 732-233-6366

E-mail address: Southern Skies Opal@questoffice.net

Signature: [Signature]

☐ Check here if this is a change of address.

BLM
Date
Stamp

PHOENIX, ARIZONA

2012 AUG 27 P 4:19

RECEIVED
BLM AZ STATE OFFICE

LINE NO.	AMC NUMBER	CLAIM/SITE NAME	COUNTY RECORDER DATA (If available)	TWP	RNG	SEC
1	410427	Closed to Entry #4	2011 - 06853	22S	11E	20
2	410428	Closed to Entry #5	2011 - 06854	22S	11E	20
3	410429	Closed to Entry #6	2011 - 06855	22S	11E	20
4	410430	Closed to Entry #7	2011 - 06856	22S	11E	20
5	410431	Closed to Entry #8	" - 06857	22S	11E	25
6	410432	Closed to Entry #9	" - 06858	22S	11E	25
7	410433	Closed to Entry #10	" 06859	22S	11E	25
8	410434	Closed to Entry #11	" - 06860	22S	11E	25
9	410435	Closed to Entry #12	" - 06861	22S	11E	25
10	410436	Closed to Entry #13	" 06862	22S	11E	25

List additional claims on Form MCF114.

Bureau of Land Management
Arizona State Office
www.blm.gov/az/

No. of Claims: 20 x \$140 = \$2800.00

Check No: 2615 Init. AA

Receipt No.: 24642091

For BLM Use Only

Form: MCF112

Revised July 2009

This form is available from the Arizona Department of Mines and Mineral Resources and may be reproduced.

Amc 410 436 listed
twice. Refund \$140

\$140 refund authorized for duplicate
maintenance fee paid on Amc 410436.

ENTERED INTO COMPUTER RE 10-26-12

9/9/12 AT

PLEASE PRESS FIRMLY



UNITED STATES POSTAL SERVICE
PITNEY BOWES
02 1P \$ 005.90⁰
0001678955 AUG 24 2012
MAILED FROM ZIP CODE 85646



Flat Rate Mailing Envelope

Visit us at usps.com

Schedule package pickup right from your home or office at usps.com/pickup
Print postage online

United States Postal Service[®]
DELIVERY CONFIRMATION[™]

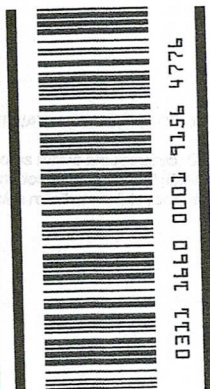

9776 9516 4776
0311 1660 0001 1000 0999

APPLY:
Visit the
usps.gov



PS00001000014

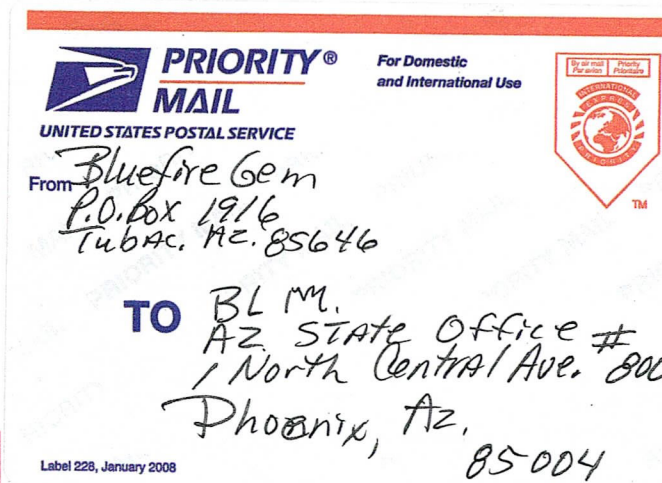

EP14F November 2011 © U.S. Postal Service
This packaging is the property of the U.S. Postal Service[®] and is provided solely for use in sending Priority Mail[®] shipments.
Misuse may be a violation of federal law. This packaging is not for resale. EP14F © U.S. Postal Service; November 2011; All served.



UNITED STATES POSTAL SERVICE

Flat Rate Mailing Envelope

Visit us at usps.com

Bluefore Gem
P.O. Box 1916
Tubac, Az.
85646.

B.L.M.
AZ. State Office
1 North Central Avenue, Suite 800
Phoenix, Az.
85004



PS00001000014

EP14F
OD: 12.5 x 9.5

United States Department of the Interior
Bureau of Land Management
LANDS/RECREATION & PLANNING
ONE N CENTRAL AVE
PHOENIX, AZ 85004 -2203
Phone: 602-417-9200

Receipt

No: 2642091

Transaction #: 2722781

Date of Transaction: 08/28/2012

CUSTOMER:

BLUE FIRE GEM COMPANY LLC
PO BOX 1916
TUBAC, AZ 85646-1916 US

LINE #	QTY	DESCRIPTION	REMARKS	UNIT PRICE	TOTAL
1	1.00	LOCATABLE MINERALS / MINING CLAIMS-NOT NEW-UNADJUD, ONE AUTH NO. ONLY / MINING CLAIM MONEY RECEIVED CASES: AMC410427/\$2800.00	MAINT FEE PYMNT (20) 2013	- n/a -	2800.00
TOTAL:					\$2,800.00

PAYMENT INFORMATION

1	AMOUNT:	2800.00	POSTMARKED:	N/A
	TYPE:	CHECK	RECEIVED:	08/27/2012
	CHECK NO:	2615		
	NAME:	OLLENDICK, ROBERT W PO BOX 1916 TUBAC AZ 85646-1916 US		

REMARKS

This receipt was generated by the automated BLM Collections and Billing System and is a paper representation of a portion of the official electronic record contained therein.

\$140 refund authorized for
duplicate maint fee paid on
AMC ~~410427~~ 410436

RE 10/16/12

NOTICE!!

These documents have been scanned!

Do not place un-scanned documents beneath this notice!

Do not remove this notice from this file!

GPO Jacket No. 560-102
Print Order 61540
Rise Business Services, LLC
Job=AZ15 5/15/2019



Box Number= AZ15051



Claim Begin-End: AMC413977-AMC413978

6 Location Notices-Amendments and Supporting Documents



AZ15051-8

AMC413769-AMC414062

MINING CLAIM STATUS REPORT

DATA
ENTERED

FEB 24 2012 *pb*

MTP Checked by

FEB 24 2012 *pb*

GEO Checked by

FEB 24 2012 *pb*

LEAD SERIAL NUMBER

AMC

413077

thru

AMC

413978

OF CLAIMS & TYPE

2 LODE
_____ PLACER
_____ ASSOCIATION PLACER
_____ MILL SITE
_____ TUNNEL SITE

CHARGES

Location Fee @ \$34 = \$ 68
Processing Fee @ \$15 = \$ 30
Maintenance Fee @ \$140 = \$ 280
Overage (+) \$ _____
Shortage (-) \$ _____
Other Fees \$ _____
TOTAL \$ 378

ARE THERE ENOUGH LOCATORS?

Yes () No () _____

DOCUMENTS RECEIVED VIA -

Over-the-Counter () Mail (☒)

TIMELY FILED?

Yes (☒) No ()

LEGAL DESCRIPTION -

T 225 R 11E SEC 25
T _____ R _____ SEC _____
T _____ R _____ SEC _____
T _____ R _____ SEC _____

BLM () FOREST SERVICE (☒) Coronado Nat. Forest SUBJ TO PL 359: Yes () No ()

WILDERNESS AREA: No () Yes () _____

SPLIT ESTATE - N/A () SX () PX () SRHA () OTHER () _____

Proper Notice Filed if Located on SHRA Lands? N/A () Yes () No ()

RECONVEYED MINERALS ON BLM LANDS REQUIRE OPENING ORDERS FROM 1944 TO 1993 -

Open to Entry on: _____ N/A ()

COMMENTS/STATUS - VOID () PARTIALLY VOID () PVT MINERALS () WITHDRAWN LANDS ()

OTHER () _____

Claimant acknowledges that portions of the following claims(s) site(s) may be void or voidable.

Printed Name of Claimant _____

Signature of Claimant _____

***** FINAL ADJUDICATION *****

DATE

6/18/2012

INITIALS

TS

AMC 413977



LOCATION NOTICE FOR LODE MINING CLAIM

NOTICE IS HEREBY GIVEN that the CLOSED TO ENTRY #17

_____ lode mining claim has been located

by Blue Fire Gem Co. LLC whose current mailingaddress is P.O. Box 1916Tubac, Az. 85646BLM
Date
Stamp2012 JAN 14 PM 1:25
ARIZONA

RECORDED

ANCH 13977

The general course of this claim is WEST TO EAST and it is situated in SANTA CRUZCounty, Arizona. This claim is 1,500 feet in length and 600 feet in width. This claim runsfrom the location monument on which this location notice is posted approximately 750 feet in adue west direction to the west end line and 750 feet in a due east direction to theeast end line. This claim is marked by six monuments, one at each corner and one at the center of each end line of the claim.The location monument on which this notice is posted is situated within Section 25, Township 22 SOUTH_____, Range 11 EAST, Gila Salt River Base and Meridian, Arizona and this claim encompasses portionsof the following quarter section (s), section (s), Township (s) and Range (s) SW 1/4, Sec. 25,T. 22 S, R 11 E.

Gila Salt River Base and Meridian, Arizona.

The locality of this claim with reference to some natural object or permanent monument and additional information

(if any) concerning its locality are as follows: slightly south and east of
CORRAL NUEVO.DATED AND POSTED on the ground this 19 day of JANUARY, 2012LOCATOR(s) Agents Vincent Gullino

Form MCF100
Revised July 2005

MINING CLAIM MAP

Lode (X) Placer ()

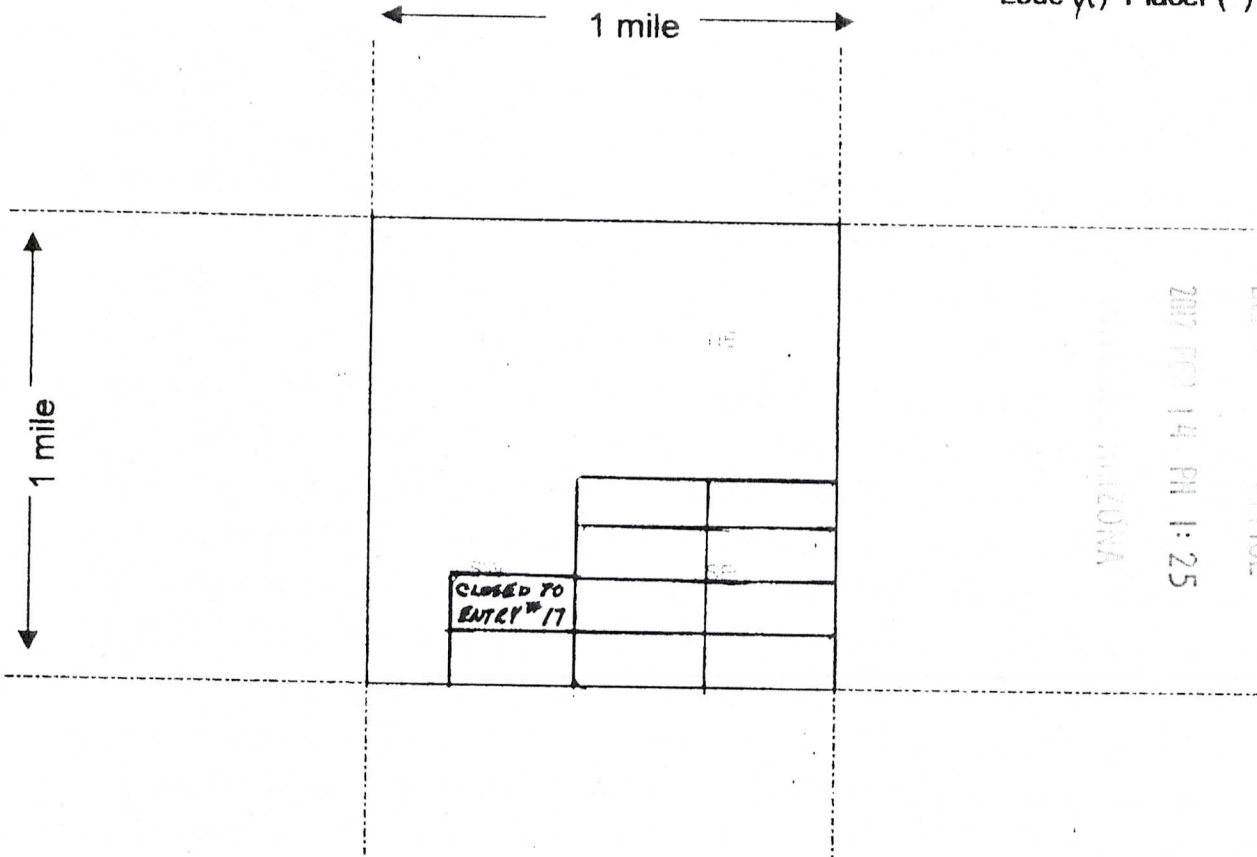

Scale : 1" = 2000 feet



1. The above map depicts the CLOSED TO ENTRY # 17 mining claim, which is located in Section (s) 25, Township 22 SOUTH, Range 11 EAST, Gila and Salt River Base and Meridian, SANTA CRUZ County, Arizona.
2. The type of corner and location monuments used are as follows: STONE AND POST
3. The bearings and distances in degrees and feet between claim corners are as depicted on the map.

Form MCF100a
Revised July 2005

This form is available from the Arizona Department of Mines & Mineral Resources and may be reproduced.

AHC413971

(CTE 16 & 17 topo.jpg):

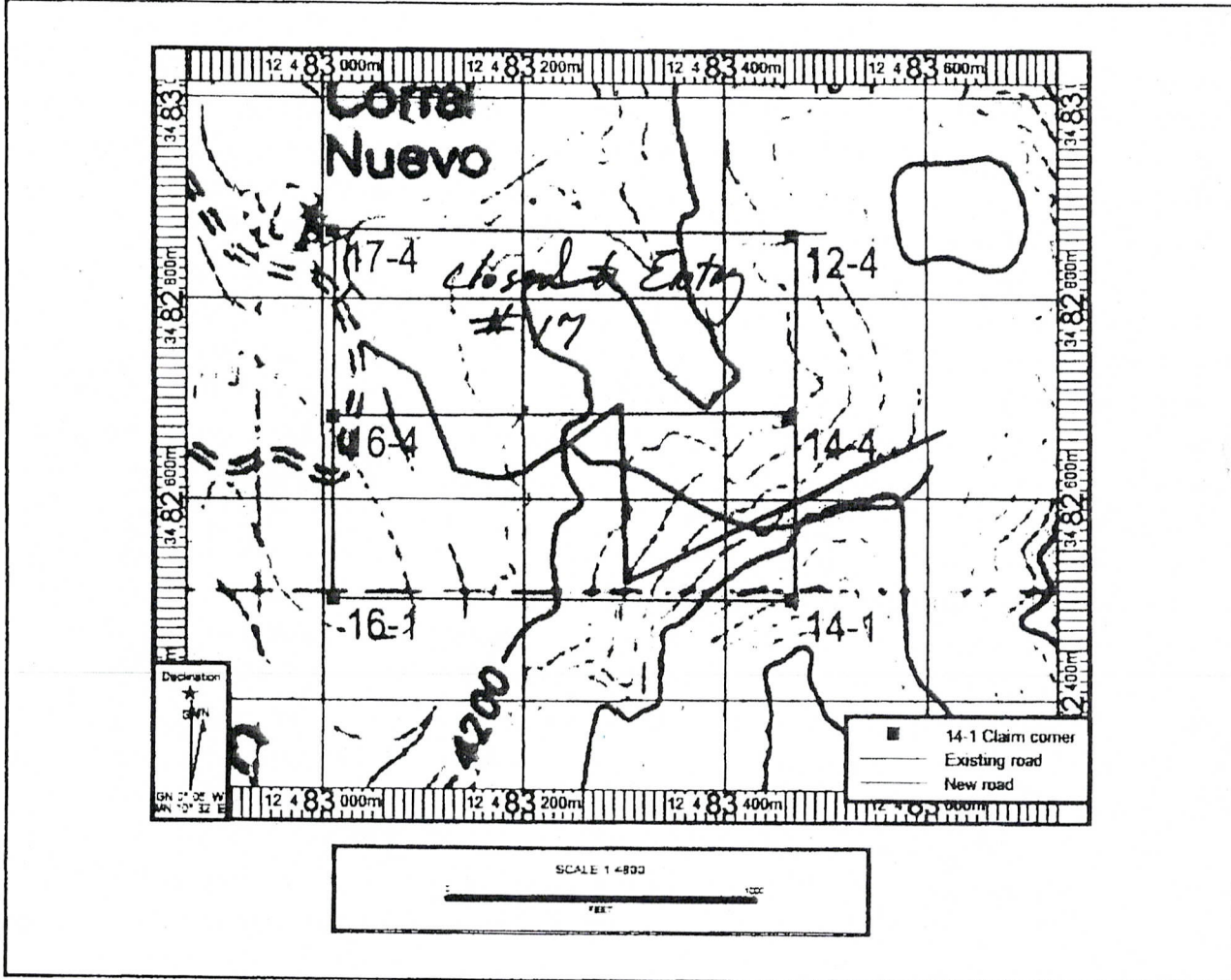

(CTE 16 & 17 aerial.jpg):

<https://webmail.centurylinkoffice.net/sitemail/reademail.php?id=9312&folder=Inbox&print=1>

2012 FEB 4 PM 1:25
RECEIVED
CENTURYLINK OFFICE

AH0413977



LOCATION NOTICE FOR LODE MINING CLAIM

NOTICE IS HEREBY GIVEN that the CLOSED TO ENTRY #16

_____ lode mining claim has been located

by BLUE FIRE Gem Co LLC whose current mailingaddress is P.O. Box 1916Tubac, Az. 85646BLM
Date
Stamp

2012 FEB 14 PM 1:25

RECORDED
BLM OFFICE

AH0413978

The general course of this claim is WEST TO EAST and it is situated in SANTA CRUZCounty, Arizona. This claim is 1,500 feet in length and 600 feet in width. This claim runsfrom the location monument on which this location notice is posted approximately 750 feet in adue WEST direction to the WEST end line and 750 feet in a due EAST direction to theEAST end line. This claim is marked by six monuments, one at each corner and one at the center of each end line of the claim.The location monument on which this notice is posted is situated within Section 25, Township 22 South_____, Range 11 EAST, Gila Salt River Base and Meridian, Arizona and this claim encompasses portionsof the following quarter section (s), section (s), Township (s) and Range (s) SW 1/4, Sec. 25,T22S, R11E

Gila Salt River Base and Meridian, Arizona.

The locality of this claim with reference to some natural object or permanent monument and additional information

(if any) concerning its locality are as follows: 600 ft south and east of
corral nuevo.DATED AND POSTED on the ground this 19 day of JANUARY, 2012.LOCATOR (s) Agent Vincent Gullino

Form MCF100
Revised July 2005

MINING CLAIM MAP

Lode (X) Placer ()

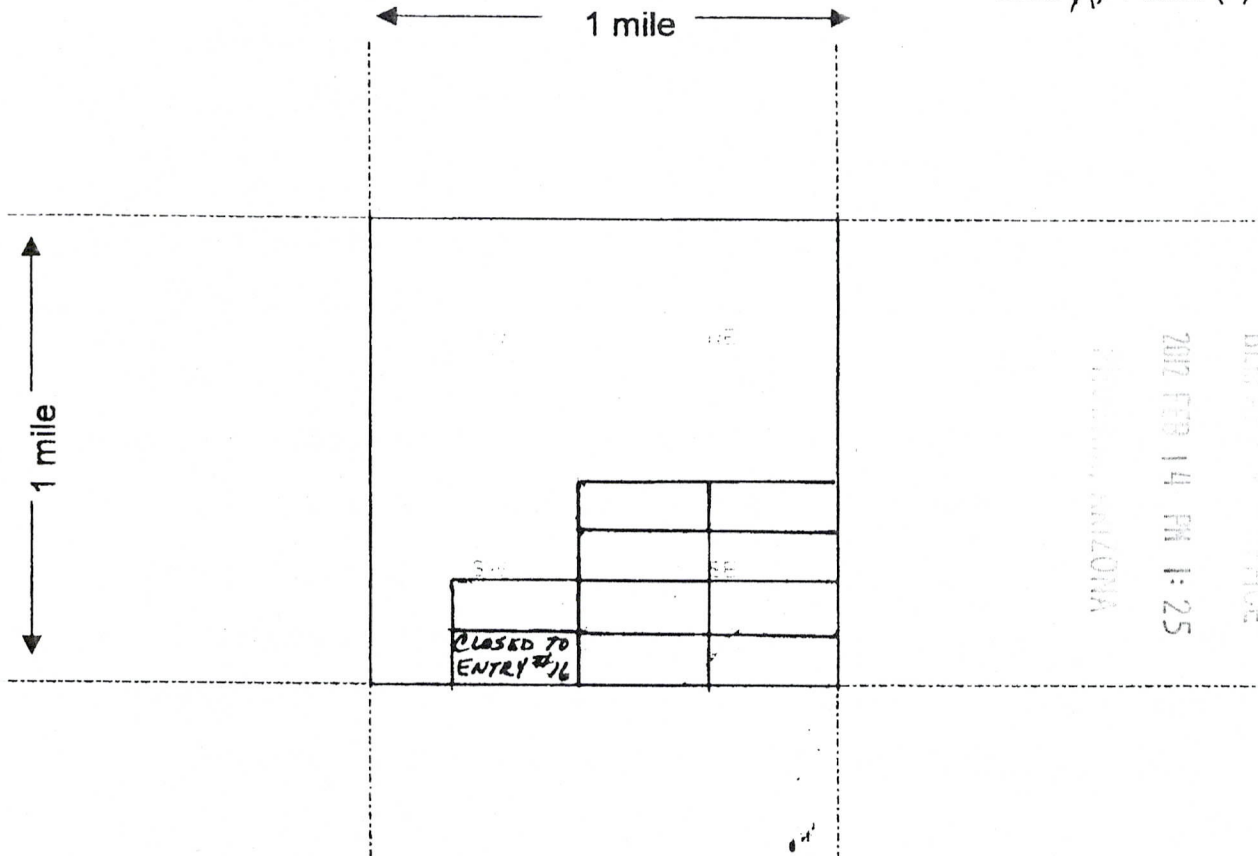

Scale : 1" = 2000 feet



1. The above map depicts the CLOSED TO ENTRY 7/6 mining claim, which is located in Section (s) 25, Township 22 SOUTH, Range 11 EAST, Gila and Salt River Base and Meridian, SANTA CRUZ County, Arizona.

2. The type of corner and location monuments used are as follows: STONE AND POST

3. The bearings and distances in degrees and feet between claim corners are as depicted on the map.

Form MCF100a
Revised July 2005

This form is available from the Arizona Department of Mines & Mineral Resources and may be reproduced.

AHC413978

(CTE 16 & 17 topo.jpg):

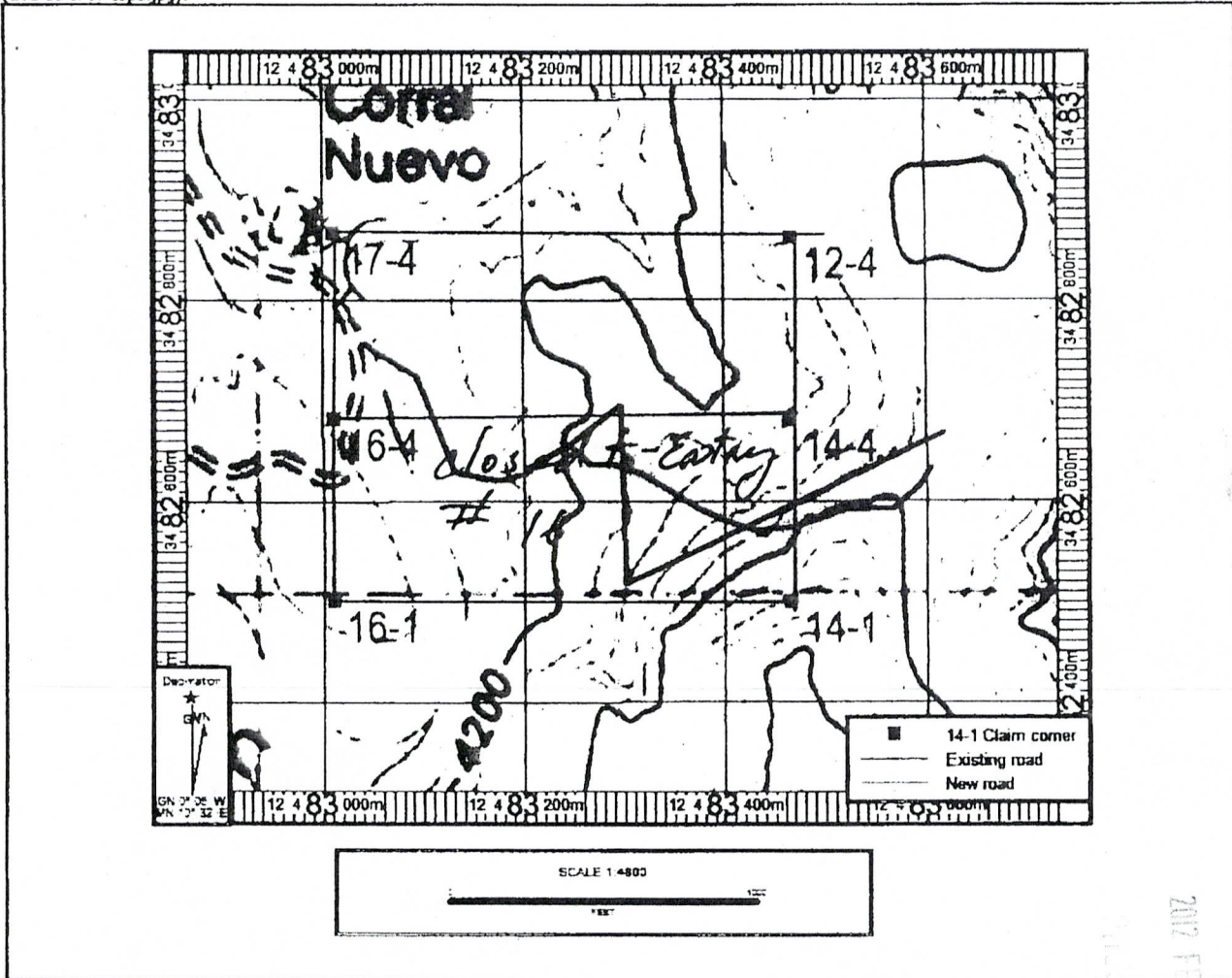

(CTE 16 & 17 aerial.jpg):

AMC413978

RECEIVED
BLM OFFICE

2012 FEB 14 PM 1:25

ARIZONA

BLUE FIRE GEM CO LLC
PO BOX 1916
TUBAC AZ 85646

CERTIFIED MAIL™

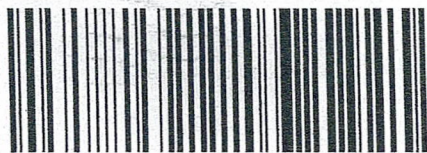

7011 0470 0000 1894 3023

TUCSON AZ 857



02 1P
0001678955 FEB 13 2012
MAILED FROM ZIP CODE 85646

PITNEY BOWES

\$ 005.950

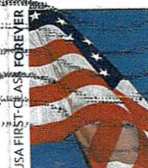

US DEPT OF THE INTERIOR
BUREAU LAND MANAGEMENT
LANDS/RECREATION & PLANNING
ONE N CENTRAL AVENUE
PHOENIX AZ 85004-2203

BLM RECEIVED
OFFICE
2012 FEB 14 PM 1:25
PHOENIX, ARIZONA

85004-2203



RUN TIME: 10:15 AM

DEPARTMENT OF INTERIOR
BUREAU OF LAND MANAGEMENT

RUN DATE: 02/24/2012
Page 1 of 1

Input Parameters for Geographic Report with Land

System Id = CR

Admin State = AZ

Geo State = AZ

Casetype Begins With

Case Disp Txt = AUTHORIZED, CANCELLED, EXPIRED, PENDING, REJECTED, RELINQUISHED, WITHDRAWN

Mer Twp Rng =

Section =

Mtrs = 14 0220S 0110E 025, 14 0220S 0110E 999

Commodity =

Commodity Txt =

Pending Org =

Pend Org Decode =

Total Rows Returned: 0

NO WARRANTY IS MADE BY BLM FOR USE OF THE DATA
FOR PURPOSES NOT INTENDED BY BLM

SANTA CRUZ / PIMA COUNTY

INDEX TO SEGREGATED TRACTS

[illegible]

DIST. NO. 4

[illegible]

T. 22S
R. 11E

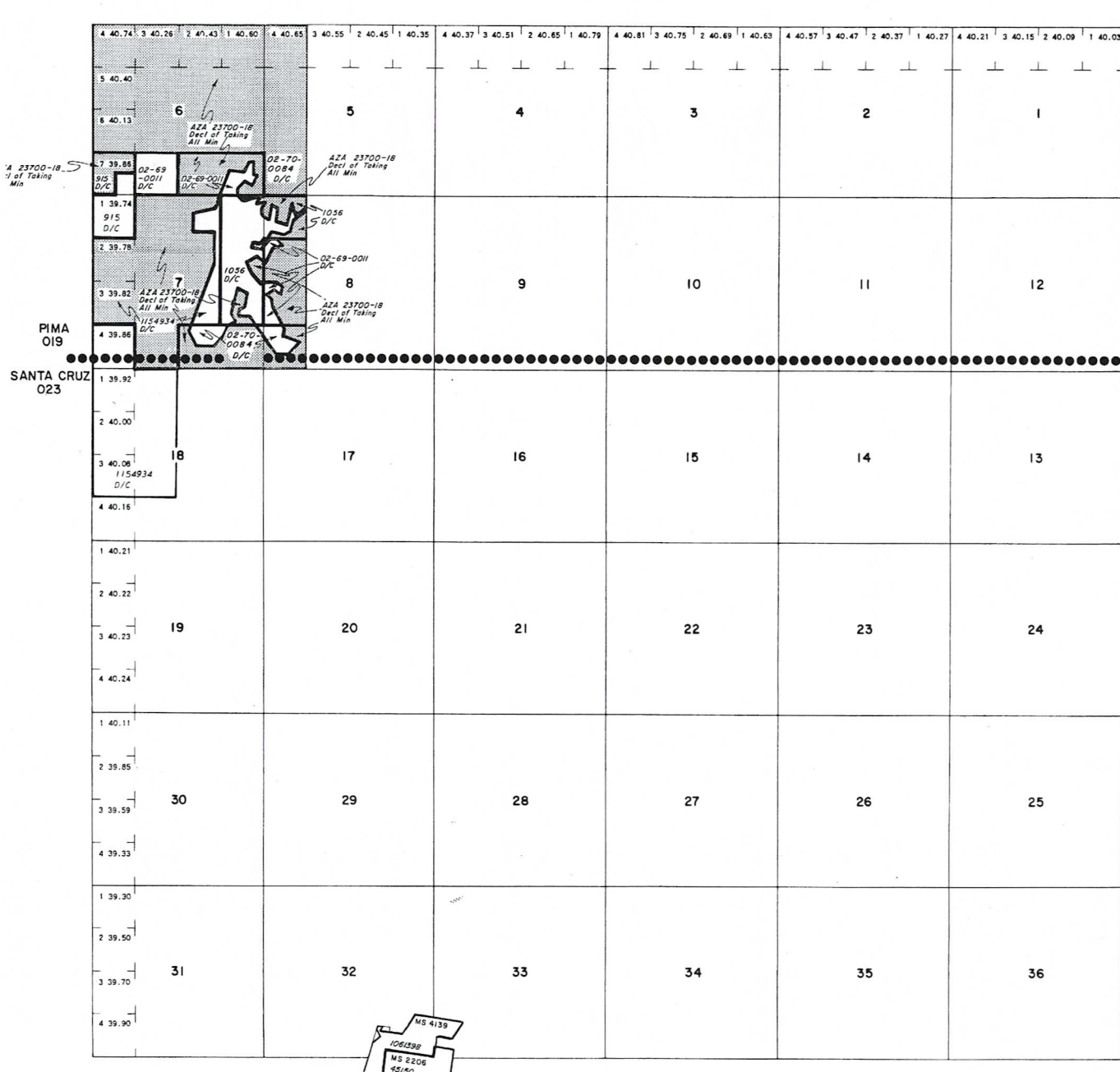

SCALE

10 20 30 60

30 chains to the inch

WARNING STATEMENT

WARNING STATEMENT

This plat is the Bureau's Record of Title, and should be used only as a graphic display of the township survey data. Records hereon do not reflect title changes which may have been effected by lateral movements of rivers or other bodies of water. Refer to the cadastral surveys for official survey information.